

Copper, DURA-LUG Super Heavy Duty Lugs, 8 Gauge to 4/0 AWG



Features and Benefits

- Chamfered Barrel Entry: Ease of Wire Insertion
- Annealed Copper Barrel: Strong Pullout Resistance
- Work-Hardened Tang: Tear Resistant
- Super Heavy Duty Wall and Tang Thickness: Corrosion and Vibration Resistant
- Extra Wide/Thick Tang: Tear Resistance for Large Studholes in Small Wire Lugs
- Oxygen Inhibitor: Corrosion/Tarnish Resistance
- Tin Plating: Corrosion Resistance
- Complete Range of Studholes: Fits Any Size
- Round Transition: Fatigue Resistance

Super Heavy Duty Tinned Copper “DURA-LUG”s

Description: ASK Power’s Super Heavy Duty Terminal Lugs incorporate Super Heavy Duty barrel walls and tang thicknesses for high-vibration or corrosion environments. The especially wide tang accommodates larger studholes in smaller gauge wire lugs for additional material around the studhole. Lugs incorporate rounded tangs, chamfered barrel entry, and steep-sloping transitions. Crimp or solder lugs. Tinned MIL-SPEC Copper. Formed from high-purity annealed copper with super heavy duty walls. Provides highest ductility, conductivity, secureness, and tang strength. Lugs accommodate wire sizes 8 Gauge through 4/0 AWG. Crimp barrels are sized to closely match commercial battery and power cable strand diameters. For crimped or soldered wire connection and bolted termination. Lugs are non-insulated. Wire gauge and crimp tool jaw code mark appear clearly on tang.

Recommended Uses: These cable lugs are used for power transmission and/or grounding in Super Heavy Duty transformer applications. Rounded tangs allow for rotation of terminals around stud connections through 360 degree rotation, where cables must enter at any angle specified. Chamfered and over-sized barrels allow for more highly-stranded battery cable to be submitted into funnel-entry crimp barrels for ease of insertion for stranded or flex cable.

Tooling and Application: Crimp lugs can be applied to cable via hand-actuated or hydraulic crimp tools. These same lugs can be connected by solder-dipping. Double crimp for long or extended barrel lugs.

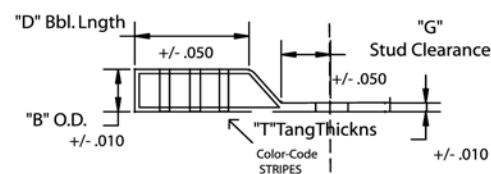
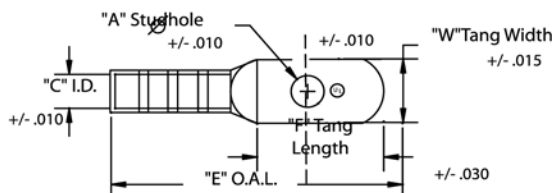

Copper, DURA-LUG Super Heavy Duty Lugs, 8 Gauge to 4/0 AWG

DURA-LUG, SUPER Heavy Duty Lug, Chamfered Barrel, Round Tang, Tinned Copper, Color and Die Coded, 8 Gauge to 4/0 AWG

ASK Part No	AWG Gauge	Nominal Stud Size	Barrel Config	Finish	Lock Lance	Barrel I.D. "C"	Barrel Lng "D"	Overall Length "E" Tol	Tang Length "F"	Tang Width "E"	Color Code	#Crimps
Tolerance						+0.010/-0.010	+/-0.030	+/-0.060	+/-0.060	+/-0.030		
DL810	8	#10	Chamfer	Tinned	No	0.180	0.350	1.170.	0.600	0.470	Red	2
DL814	8	1/4	Chamfer	Tinned	No	0.180	0.350	1.170.	0.600	0.470	Red	2
DL8516	8	5/16	Chamfer	Tinned	No	0.180	0.350	1.170.	0.600	0.625	Red	2
DL838	8	3/8	Chamfer	Tinned	No	0.180	0.350	1.370	0.600	0.625	Red	2
DL812	8	1/2	Chamfer	Tinned	No	0.180	0.350	1.370	0.760	0.650	Red	2
DL610	6	#10	Chamfer	Tinned	No	0.235	0.400	1.425	0.760	0.470	Blue	2
DL614	6	1/4	Chamfer	Tinned	No	0.235	0.400	1.425	0.760	0.470	Blue	2
DL6516	6	5/16	Chamfer	Tinned	No	0.235	0.400	1.425	0.760	0.625	Blue	2
DL638	6	3/8	Chamfer	Tinned	No	0.235	0.400	1.425	0.760	0.625	Blue	2
DL638LL	6	3/8	Chamfer	Tinned	Yes	0.235	0.400	1.425	0.760	0.625	Blue	2
DL612	6	1/2	Chamfer	Tinned	No	0.235	0.400	1.615	0.830	0.700	Blue	2
DL414	4	1/4	Chamfer	Tinned	No	0.275	0.500	1.680	0.830	0.550	Gray	2
DL4516	4	5/16	Chamfer	Tinned	No	0.275	0.500	1.680	0.830	0.705	Gray	2
DL438	4	3/8	Chamfer	Tinned	No	0.275	0.500	1.680	0.830	0.705	Gray	2
DL438LL	4	3/8	Chamfer	Tinned	Yes	0.275	0.500	1.680	0.830	0.705	Gray	2
DL4 1/2.	4	1/2	Chamfer	Tinned	No	0.275	0.500	1.680	0.830	0.705	Gray	2
DL1214	2	1/4	Chamfer	Tinned	No	0.385	0.600	1.865	0.860	0.795	White	2
DL12516	2	5/16	Chamfer	Tinned	No	0.385	0.600	1.865	0.860	0.795	White	2
DL1238	2	3/8	Chamfer	Tinned	No	0.385	0.600	1.865	0.860	0.795	White	2
DL1238LL	2	3/8	Chamfer	Tinned	Yes	0.385	0.600	1.865	0.860	0.795	White	2
DL1212	2	1/2	Chamfer	Tinned	No	0.385	0.600	1.865	0.860	0.795	White	2
DL1014	1/0	1/4	Chamfer	Tinned	No	0.445	0.850	2.040	0.960	0.860	Pink	2
DL10516	1/0	5/16	Chamfer	Tinned	No	0.445	0.850	2.040	0.960	0.860	Pink	2
DL1038	1/0	3/8	Chamfer	Tinned	No	0.445	0.850	2.040	0.960	0.860	Pink	2
DL1038LL	1/0	3/8	Chamfer	Tinned	No	0.445	0.850	2.040	0.960	0.860	Pink	2
DL1012	1/0	1/2	Chamfer	Tinned	Yes	0.445	0.850	2.040	1.000	0.860	Pink	2
DL2014	2/0	1/4	Chamfer	Tinned	No	0.485	0.850	2.400	1.000	0.925	Black	2
DL20516	2/0	5/16	Chamfer	Tinned	No	0.485	0.850	2.400	1.000	0.925	Black	2
DL2038	2/0	3/8	Chamfer	Tinned	No	0.485	0.850	2.400	1.000	0.925	Black	2
DL2038LL	2/0	3/8	Chamfer	Tinned	Yes	0.485	0.850	2.400	1.000	0.925	Black	2
DL2012	2/0	1/2	Chamfer	Tinned	No	0.485	0.850	2.400	1.000	0.925	Orange	2
DL3014	3/0	1/4	Chamfer	Tinned	No	0.550	0.850	2.460	1.100	1.030	Orange	2
DL30516	3/0	5/16	Chamfer	Tinned	No	0.550	0.850	2.460	1.100	1.030	Orange	2
DL3038	3/0	3/8	Chamfer	Tinned	No	0.550	0.850	2.460	1.100	1.030	Orange	2
DL3038LL	3/0	3/8	Chamfer	Tinned	Yes	0.550	0.850	2.460	1.100	1.030	Orange	2
DL3012	3/0	1/2	Chamfer	Tinned	No	0.550	0.850	2.460	1.100	1.030	Orange	2
DL4014	4/0	1/4	Chamfer	Tinned	No	0.630	0.850	2.470	1.020	1.150	Purple	2
DL40516	4/0	5/16	Chamfer	Tinned	No	0.630	0.850	2.470	1.020	1.150	Purple	2
DL4038	4/0	3/8	Chamfer	Tinned	No	0.630	0.850	2.470	1.020	1.150	Purple	2
DL4038LL	4/0	3/8	Chamfer	Tinned	Yes	0.630	0.850	2.470	1.020	1.150	Purple	2
DL4012	4/0	1/2	Chamfer	Tinned	No	0.630	0.850	2.470	1.020	1.150	Purple	2

Product Options

- For Bent Tang Lugs, add "45" or "90" to end of part number.
- "LL" signifies "Locking Lances" for anti-rotation. Stackable at 90 Degree angle. (See Page 17 for detail)
- For special tang widths, stud clearances, barrel lengths, or any option you don't see, contact the Plant.